

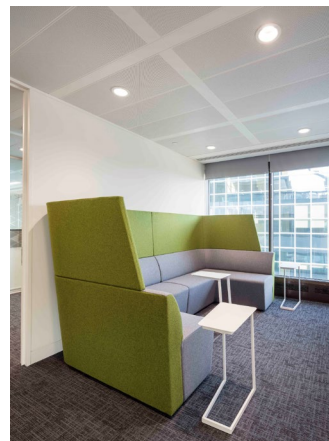

Downing 

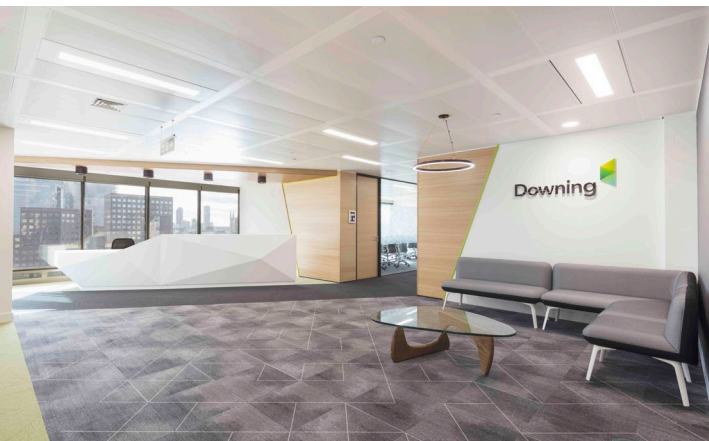

The Brief

Downing, a leading B-Corp investment management business, and long-standing client of Blue Jelly needed to create a new London workplace that sets the right impression for both clients and employees. The long established investment management firm wanted the space to feel spacious, light and welcoming with flexible areas for collaboration with consideration given to Wellbeing.

What we did

Through a series of team engagement sessions, we assisted Downing in developing the brief. Taking into consideration the different work activities across departments, the company culture Downing was building and the need to appeal to clients. We provided space analysis based on headcount projections to enable Downing to make informed decisions about the space required for the duration of their lease. A focal area in the design was the main breakout area which includes a large lounge with open booth seating and a dining table that doubles as a collaboration space. There's a proper coffee machine and the space has premium finishes to make it perfect for client entertainment. Adjacent to this is a games room with café style seating. The design included a suite of meeting rooms including a large boardroom, a flexible meeting space with a bi-fold door enabling it to become two small spaces and several additional meeting rooms. Throughout the main open plan, there are spaces to collaborate and have informal meetings including an alcove fitted with a large soft seating area and laptop tables. With team wellbeing at the centre of the design decisions each workstation included sit-stand desks. Hidden from view there's extensive acoustic work to provide confidential cellular spaces and a new fresh air system.

The Results

This new workplace enables the Downing team to work effectively whilst giving them the space needed to entertain clients and expand as they grow.



18,000 sq ft

| The City, London

| 12 Weeks

BlueJelly.

Downing